

GENERAL CHARACTERISTICS

Flowmeter operates according to variable area principle with a cylindrical float moving flow-dependently in a conical metering tube.

- * dual scale LPM and LPH
- * full face scale print

female thread NPT3/4" PVC



UK-048GHW0045

TECHNICAL DATA

	NPT	Type	PN bar	metering range dual scale LPM and LPH			weight kg
H ₂ O	NPT 3/4"	UK-048GHW0045	6	5 - 45 l/min	300 - 2700 l/h	0.45	
		UK-048GHW0060	6	6 - 60 l/min	360 - 3600 l/h		
		UK-048GHW0070	6	8 - 70 l/min	480 - 4200 l/h		
air	NPT 3/4"	UK-048GHL0140	6	150 - 1400 NI/min	9000 - 84000 NI/h	0.45	
		UK-048GHL0180	6	200 - 1800 NI/min	12000 - 108000 NI/h		
		UK-048GHL0220	6	200 - 2200 NI/min	12000 - 132000 NI/h		

tolerance ±3% of full scale
 media temperature max. 65°C

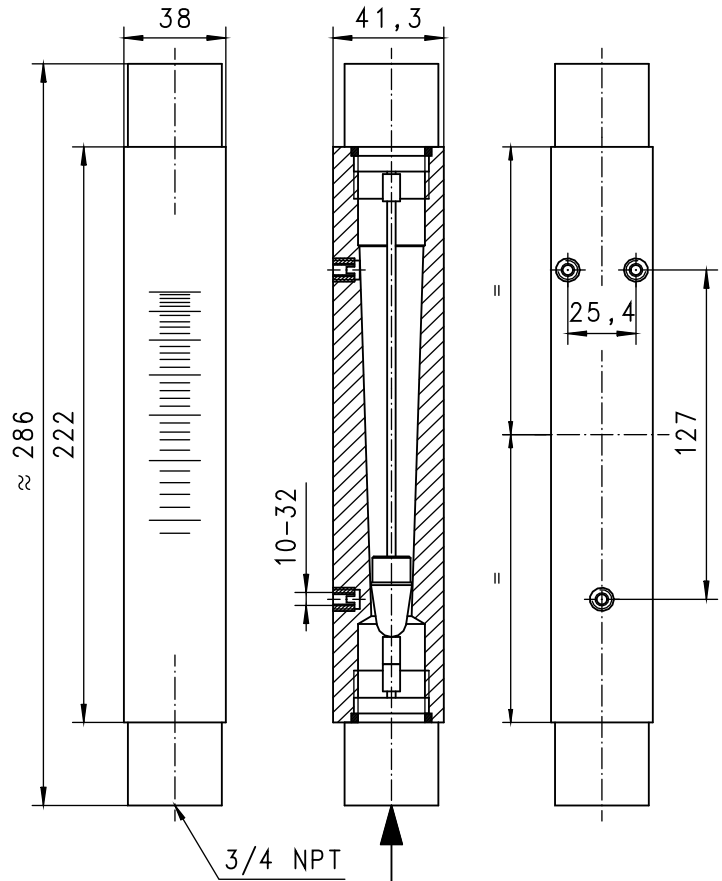

MATERIALS

housing acrylic
 float aluminum / stainless steel
 connectors PVC
 seal NBR

ELECTRICAL DATA

No electrical components.

MOUNTING POSITION

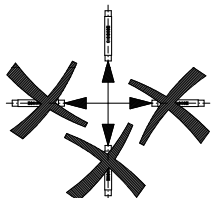

METERING SUBSTANCES

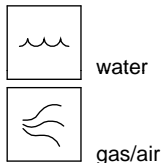

water

gas/air

NOMENCLATURE

For combinations see table "technical data".

UK-	048	G	H	W0010		basic type	
UK-					●	Flowmeter	
	048				●	instrument series 048 , female thread NPT 3/4"	
		G			●	female thread	
			H		●	PVC	
				W0045	●	metering range	
				W0060	●		5 - 45 l/min water 300 - 2700 l/h water
				W0070	●		6 - 60 l/min water 360 - 3600 l/h water
				L0140	●		8 - 70 l/min water 480 - 4200 l/h water
				L0180	●		150 - 1400 NI/min air 9000 - 84000 NI/h air
				L0220	●		200 - 1800 NI/min air 12000 - 108000 NI/h air
Special option					□	200 - 2200 NI/min air 12000 - 132000 NI/h air	
VARIO						seal Viton	
						special scales	

IMPORTANT FOR YOUR ORDER

- With gaseous media indicate pressure (relative or absolute), temperature and metering substance, e.g. air (metering range on request)

All technical changes reserved

IBASIC Standard ○BASIC Programme option □VARIO Special option ⊕ PLUS Accessories

X not recommendable