

**GENERAL CHARACTERISTICS**

Instruments operate by a spring-supported paddle with magnetic triggering of a micro switch.

- \* good repeatability
- \* low pressure loss
- \* dirt resistant
- \* hermetic separation of electrical and hydraulic components
- \* high switch capability

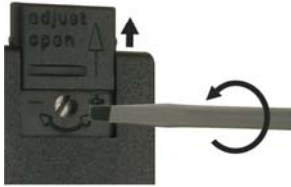

Female thread G3/8 to G2 brass/stainless steel



**UM3K-015GM065**

**TECHNICAL DATA**

|                 | G       | Type          | PN bar | Qmax. recom. l/min H <sub>2</sub> O | adjustable range l/min H <sub>2</sub> O | H mm | L mm | X mm | weight kg |
|-----------------|---------|---------------|--------|-------------------------------------|---|------|------|------|-----------|
| brass           | G 3/8   | UM3K-010GM055 | 25     | 10                                  | 4 - 5.5                                 | 87   | 50   | 10   | 0.35      |
|                 | G 1/2   | UM3K-015GM070 | 25     | 20                                  | 5.5 - 7                                 | 87   | 50   | 10   | 0.35      |
|                 | G 3/4   | UM3K-020GM100 | 25     | 40                                  | 7.5 - 10                                | 88   | 50   | 12   | 0.35      |
|                 | G 1     | UM3K-025GM180 | 25     | 60                                  | 14 - 18                                 | 92   | 50   | 12   | 0.40      |
|                 | G 1 1/4 | UM3K-032GM300 | 25     | 80                                  | 22 - 30                                 | 96   | 50   | 12   | 0.55      |
|                 | G 1 1/2 | UM3K-040GM500 | 25     | 100                                 | 37 - 50                                 | 99   | 50   | 12   | 0.60      |
|                 | G 2     | UM3K-050GM930 | 25     | 150                                 | 67 - 93                                 | 108  | 50   | 12   | 1.00      |
| stainless steel | G 3/8   | UM3K-010GK055 | 25     | 10                                  | 4 - 5.5                                 | 87   | 50   | 10   | 0.40      |
|                 | G 1/2   | UM3K-015GK070 | 25     | 20                                  | 5.5 - 7                                 | 87   | 50   | 10   | 0.41      |
|                 | G 3/4   | UM3K-020GK100 | 25     | 40                                  | 7.5 - 10                                | 88   | 50   | 12   | 0.35      |
|                 | G 1     | UM3K-025GK180 | 25     | 60                                  | 14 - 18                                 | 92   | 50   | 12   | 0.45      |
|                 | G 1 1/4 | UM3K-032GK300 | 25     | 80                                  | 22 - 30                                 | 96   | 50   | 12   | 0.55      |
|                 | G 1 1/2 | UM3K-040GK500 | 25     | 100                                 | 37 - 50                                 | 99   | 50   | 12   | 0.70      |
|                 | G 2     | UM3K-050GK930 | 25     | 150                                 | 67 - 93                                 | 108  | 50   | 12   | 1.00      |

Adjustable range is indicated for horizontally decreasing flow.

|                       |   |
|-----------------------|---|
| tolerance             | ±15% of full scale                              |
| media temperature     | max. 110°C                                      |
| average pressure loss | 0.01bar at Qmax.                                |
| hysteresis            | depending on switch value<br>minimum 0.7 l/min. |

**MATERIALS**

|         | <b>UM3K-...GM</b>                  | <b>UM3K-...GK</b>                  |
|---------|------------------------------------|------------------------------------|
| housing | brass Ms58<br>nickel plated        | stainless steel 1.4305             |
| body    | brass Ms58<br>nickel plated        | stainless steel 1.4571             |
| paddle  | stainless steel 1.4301 ;<br>1.4571 | stainless steel 1.4301 ;<br>1.4571 |
| spring  | stainless steel 1.4310             | stainless steel 1.4310             |
| magnet  | oxyd 300                           | oxyd 300                           |
| seal    | NBR                                | viton                              |

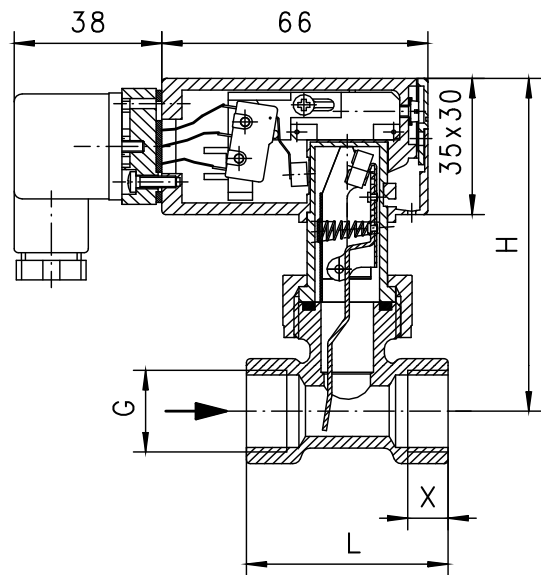

**ELECTRICAL DATA**

micro switch - wiring 0.371 change over  
250 V AC 5 A  
plug DIN 43650-A  
protection class 2  
protection class IP 65

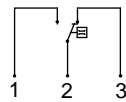

**OBASIC**  
Programme options

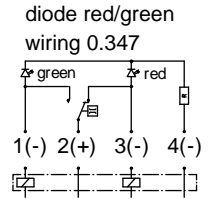
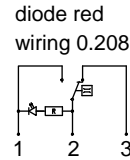
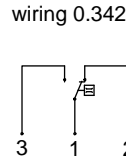

**MOUNTING POSITION**

Installation position may influence switch value.

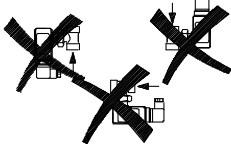

**METERING SUBSTANCES**

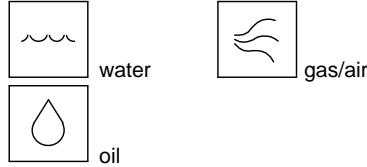

**NOMENCLATURE**

For combinations see table "technical data"

| UM3K-                  | 10 | G | M | 050 |   | basic type specification  |
|------------------------|----|---|---|-----|---|---|
|                        | 10 |   |   |     | ● | nominal diameter DN 10 - G3/8   |
|                        | 15 |   |   |     | ● | nominal diameter DN 15 - G1/2   |
|                        | 20 |   |   |     | ● | nominal diameter DN 20 - G3/4   |
|                        | 25 |   |   |     | ● | nominal diameter DN 25 - G1   |
|                        | 32 |   |   |     | ● | nominal diameter DN 32 - G1 1/4   |
|                        | 40 |   |   |     | ● | nominal diameter DN 40 - G1 1/2   |
|                        | 50 |   |   |     | ● | nominal diameter DN 50 - G2   |
|                        |    | G |   |     | ● | female thread   |
|                        |    |   | M |     | ● | brass design  |
|                        |    |   | K |     | ● | stainless steel design  |
|                        |    |   |   | 055 | ● | Verstellbereich H <sub>2</sub> O horizontal 4 - 5.5 l/min   |
|                        |    |   |   | 070 | ● | Verstellbereich H <sub>2</sub> O horizontal 5.5 - 7 l/min   |
|                        |    |   |   | 100 | ● | Verstellbereich H <sub>2</sub> O horizontal 7.5 - 10 l/min  |
|                        |    |   |   | 018 | ● | Verstellbereich H <sub>2</sub> O horizontal 14 - 18 l/min   |
|                        |    |   |   | 300 | ● | Verstellbereich H <sub>2</sub> O horizontal 22 - 30 l/min   |
|                        |    |   |   | 500 | ● | Verstellbereich H <sub>2</sub> O horizontal 37 - 50 l/min   |
|                        |    |   |   | 930 | ● | Verstellbereich H <sub>2</sub> O horizontal 67 - 93 l/min   |
| Programme option BASIC |    |   |   |     | ○ | wiring 0.208 - diode red integrated in plug DIN 43650-A<br>wiring 0.347 - diode red/green integrated in plug DIN 43650-A<br>wiring 0.342<br>gold-plated micro switch 125 V AC / 30 V DC / 100mA |
| Special option VARIO   |    |   |   |     | □ | setting / adjustable ranges for oil or gas<br>contact for locking plug M12x1, 4-pole<br>minimal flow range  |

**IMPORTANT FOR YOUR ORDER**

- Please indicate flow direction, metering substance and adjustable range with your order.
- With viscous liquids please indicate viscosity, temperature and metering substance (adjustable range on request)
- With gaseous media indicate pressure (relative or absolute), temperature and metering substance (adjustable range on request)

**HONSBERG COMBINATION SYSTEM**

connection types for UM3K

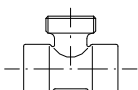

**female thread**  
brass  
stainless steel

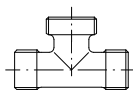

**male thread**  
brass  
POM



**welding, soldering  
glue socket**  
brass, stainless steel, PVC



**solder fitting**  
copper

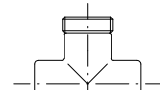

**glue fitting**  
PVC

All technical changes reserved

IBASIC Standard ○OBASIC Programme option □VARIO Special option ⊕ PLUS Accessories

**X** not recommendable