

GENERAL CHARACTERISTICS

Mechanical Level Switch in full metal design for liquids. A magnet-equipped float triggers a pre-fixed reed switch.

- * wall mounting
- * reliable
- * high temperature
- * good repeatability

Male thread 1/8 BSPP - 1/2 BSPT stainless steel



TECHNICAL DATA

pressure	RW-015HKS PN 5 bar
media temperature	max. 120°C
weight	110g
liquid density	≥0.75 g/cm³

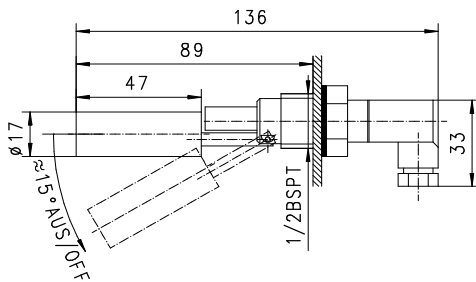

pressure	RW-015HKL PN 6 bar
media temperature	max. 200°C
weight	120 g
liquid density	≥0,70 g/cm³

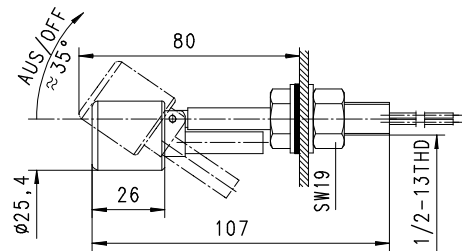

MATERIALS

body	RW-015HKS stainless steel 1.4301	RW-015HKL stainless steel 1.4571
float	stainless steel 1.4436	stainless steel 1.4571

MOUNTING POSITION

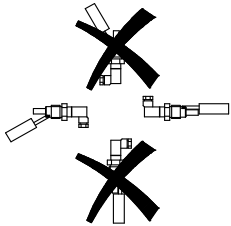

Installation position may influence operation!

ELECTRICAL DATA

reed switch	0.225 n.c. or n.o. depending on installation position
wiring	50 V AC 0.5 A 25 VA
plug design	plug similar to DIN 43650-C
	contact distance 9.4mm
lead design	220 V AC 0,28 A 30 VA
	lead 600 mm
protection class	IP 65

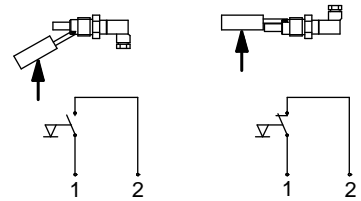

METERING SUBSTANCES

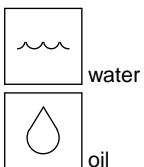

NOMENCLATURE

RW-	015	H	K	S	basic type
	015				specification
		H			● connection thread 1/2 BSPT
			K		● socket thread
				S	● stainless steel
				L	● plug (only RW-015)
					● leads

All technical changes reserved

●BASIC Standard ○BASIC Programme option □VARIO Special option ⊕ PLUS Accessories ✗ not recommendable