

**GENERAL CHARACTERISTICS**

Mechanical Level Indicator for liquids. In a sight glass a float optically indicates the actual level.

- \* top assembly
- \* direct indication

Male thread G3/8A brass



**NBS-010HM080**

**TECHNICAL DATA**

media temperature max. 50°C  
 weight 95g (NBS-010HM040)  
 195g (NBS-010HM300)

length 40-200 from length 250

vent hole  
 in the cover

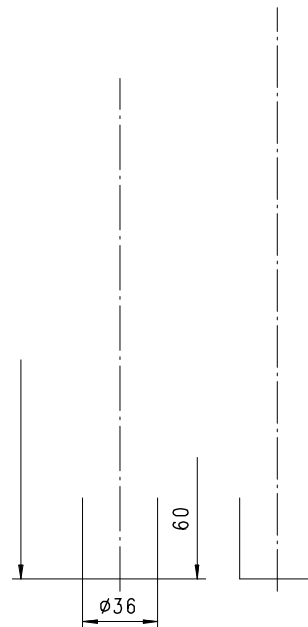

**MATERIALS**

body brass  
 tube natural glass  
 sight ring PVC  
 rod acrylic  
 float spansil  
 buffer NBR

**MOUNTING POSITION**

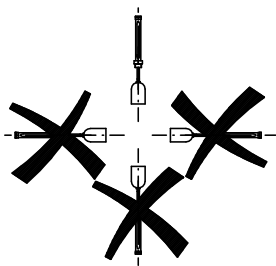

**NOMENCLATURE**

NBS-	010	H	M	040	basic type specification
	010				● connection thread G3/8A
		H			● socket thread
			M		● brass
				040	● length 40 mm
				060	● length 60 mm
				080	● length 80 mm
				100	● length 100 mm
				125	● length 125 mm
				150	● length 150 mm
				200	● length 200 mm
				250	● length 250 mm
				300	● length 300 mm
Special option VARIO					<input type="checkbox"/> length 50,70,90,175 and >300 mm connection thread G1/2A

**METERING SUBSTANCES**

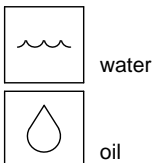

All technical changes reserved

●BASIC Standard ○BASIC Programme option □VARIO Special option ⊕ PLUS Accessories ✗not recommendable